

U | Contact



**The gigabit terminal block – the new connection system  
for data cables in wall-mounted devices**

Members of METZ CONNECT

# Future-oriented product innovation

## New: the Ethernet-compatible gigabit terminal block for wall-mounted devices

METZ CONNECT has launched a new generation of connection systems. The substantial increase in devices linked via a permanent cable connection, such as network-compatible cameras, WiFi spots, room temperature controllers, house telephones, time capture systems, fire protection, alarm and access control systems, has led to METZ CONNECT developing a future-oriented product innovation which offers an intelligent alternative solution for pluggable RJ45 solutions for wall-mounted devices with a permanent cable connection.

**The new gigabit terminal block by METZ CONNECT is a high performance, Ethernet-compatible connection system for data cables in wall-mounted devices with a permanent cable connection.**

The advantages of direct connections for wall-mounted devices are obvious. Compact design for flat devices, improved safety through internal connections, cost advantages through system connections as well as optimal connection friendliness, perfect network cabling for the wall-mounted devices of tomorrow.

On the normative side, the foundations are presently being laid for the implementation of direct wire connections in the market, something which is already standard in other countries.

## Different applications in buildings

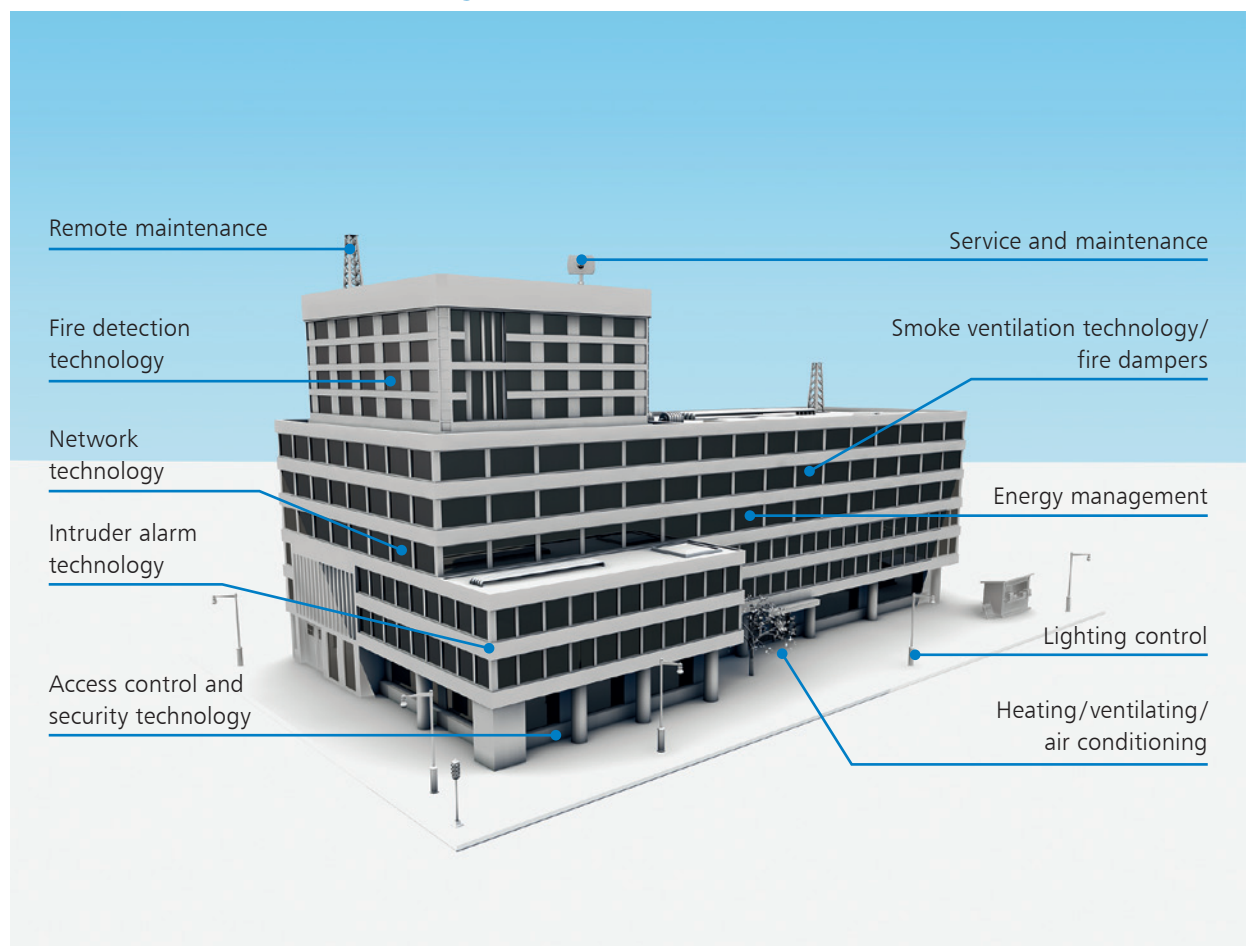

# Application options

## Application



### Heating/ventilating/air conditioning

heating controls  
air conditioning controls  
ventilation systems  
thermostats  
sensor systems etc.

---



### Access control systems

intercom systems  
electronic key systems  
card readers etc.

---



### Surveillance technology

video surveillance  
motion sensors  
surveillance units etc.

---



### Fire protection technology

fire detection systems  
fire detectors etc.

---



### Network technology

WiFi-Spot  
Router etc.

# The gigabit terminal block: versatile, compact and high performance

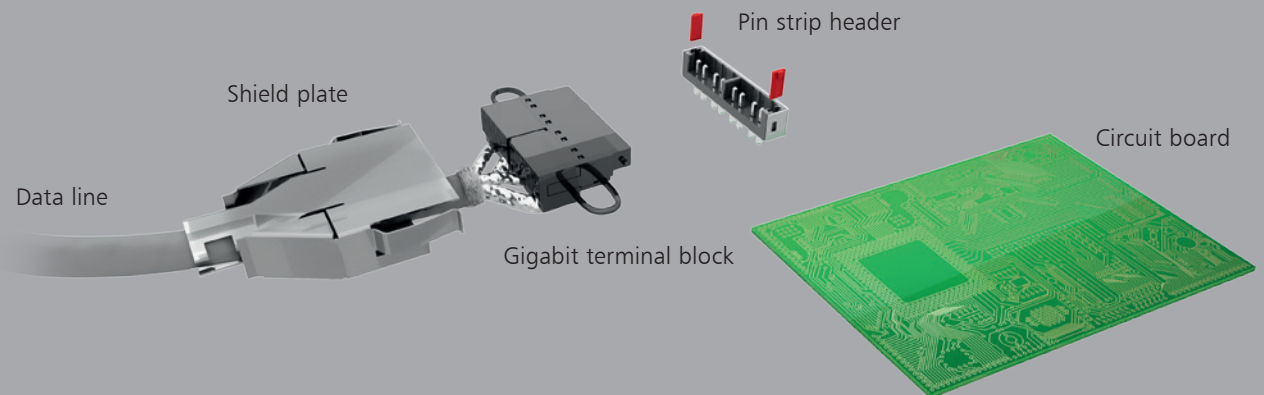

## Convincing technical features

The new METZ CONNECT gigabit terminal block is available as pluggable version for pin strips to connect shielded and unshielded data cables to circuit boards. Contact is via IDC contacts. The connection is suitable for 2-pair and 4-pair cables (twisted pair) type AWG 26/7 – 22/7 (braid) and AWG 24/1 – 22/1 (solid wire).

Full shielding of the terminal block via a metal cover is available as an option; PoE+ capable to IEEE 802.3.at. At the same time this terminal block offers data transmission in the gigabit range.

## Designed to meet requirements

In most applications unshielded cabling will be sufficient for wall-mounted devices with a permanent cable connection. However, one should always consider the application in question: for example, if electromagnetic effects interfere with data transmission, then a shielded system should be used.



unshielded version

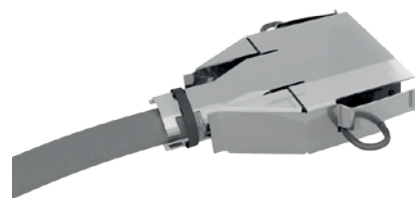

shielded version

## Major benefits for the future

The Ethernet-compatible, direct connection gigabit and megabit terminal block for data cables is the future of connection technology for wall-mounted devices. With all its advantages it represents an intelligent alternative to RJ45 solutions.

- System data cable connection with Ethernet data transmission up to gigabit range
- Cost advantages of system connection
- Internal connection increases safety
- Compact design for flat devices
- Saves space in the device
- Reduces connection times and costs
- Optional full shielding is possible
- Suitable for 2-pair and 4-pair data lines (twisted pair)  
type AWG 26/7 – 22/7 (braid) and AWG 24/1 – 22/1 (solid wire)
- PoE+ possible
- User-friendly connection
- No visible cables on the device (cable entry on wall-mounted side of the device)
- Pluggable solution (terminal and pin strip) for two halves of the housing (sandwich design)
- Cable connection does not require special tools
- Cable inspection is possible with auxiliary aids (i.e. measuring cables)
- EMV conformity

### 4-pin megabit terminal block

with various plug directions

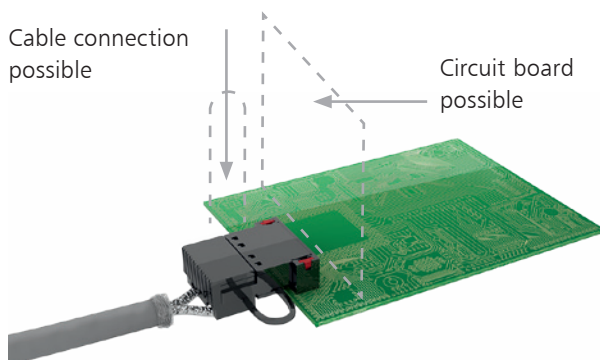

### 8-pin gigabit terminal block

with various plug directions

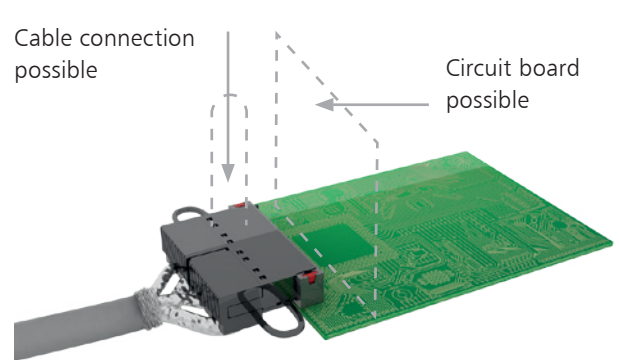

# The idea behind the system

At METZ CONNECT the focus is on a system concept, whereby the use of the gigabit terminal block offers numerous advantages. For example, a direct connection of the installation cable (permanent link) is possible without requiring a pre-fabricated patch cable, a plug for field assembly or special tools. Furthermore, one can save on a connection box and shorten the link.

## Today's connection for wall-mounted devices

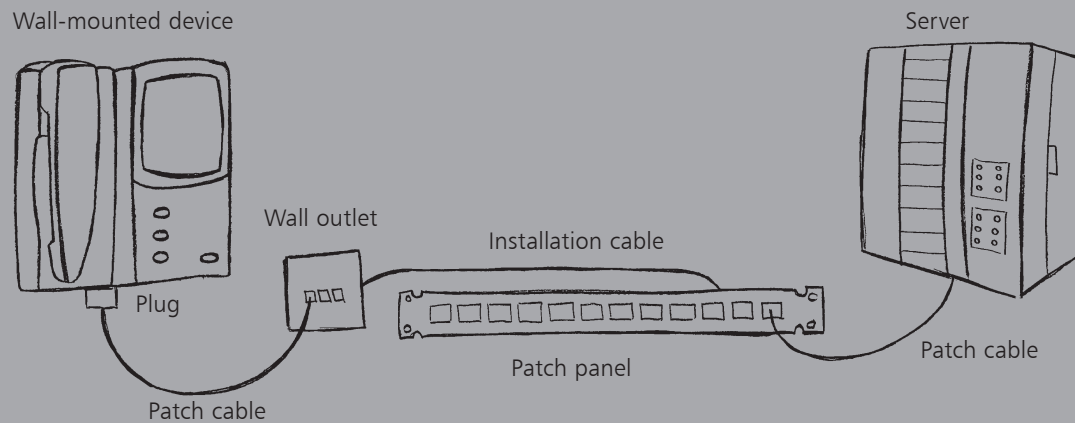

## Tomorrow's connection for wall-mounted devices

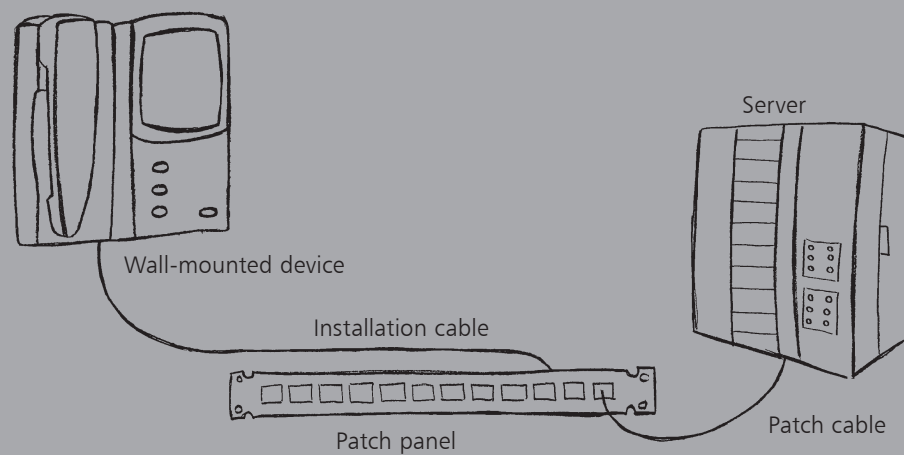

# Range of products



4-pin megabit terminal block without shield  
2-pair connection  
**IP31S04ZBNN**



4-pin megabit terminal block with shield  
2-pair connection  
**IP31S04ZBSN**



8-pin gigabit terminal block without shield  
4-pair connection  
**IP31S08ZBNN**



8-pin gigabit terminal block with shield  
4-pair connection  
**IP31S08ZBSN**



4-pin pin strip header without shielding  
**PR31S04ZBNN**



4-pin pin strip header with shielding  
**PR31S04ZBSN**



8-pin pin strip header without shielding  
**PR31S08ZBNN**



8-pin pin strip header with shielding  
**PR31S08ZBSN**

## Additional product features

- Angle of connection 90° (horizontal) / plug direction
- Angle cable connection 0° (vertical) / plug direction
- Optional mounting to housing via slot mounting with snap-in elements etc.

BTR NETCOM GmbH is member in the following organizations and associatons.



**We realize ideas**

**RIA CONNECT GmbH | BTR NETCOM GmbH**

Im Tal 2  
78176 Blumberg  
Germany

Phone +49 77 02 533-0  
Fax +49 77 02 533-189

info@metz-connect.com  
www.metz-connect.com

**RIA CONNECT, Inc.**

200 Tornillo Way  
Tinton Falls, NJ 07712  
USA  
Phone +1-732-389-1300  
Fax +1-732-389-9066  
www.metz-connect.com

**BTR NETCOM, Inc.**

200 Tornillo Way  
Tinton Falls, NJ 07712  
USA  
Phone +1-732-380-8145  
Fax +1-732-389-8147  
www.metz-connect.com

**METZ CONNECT France SAS**

28, Rue Schweighaeuser  
67000 Strasbourg  
France  
Phone +33 3886 17073  
Fax +33 3886 19473  
www.metz-connect.com

**METZ CONNECT**

Ulitsa Twerskaja 16 | Building 1  
125009 Moscow  
Russian Federation  
Phone +7.495.228.37.88  
Fax +7.495.935.89.62  
www.metz-connect.com

**METZ CONNECT (SINGAPORE) PTE. LTD.**

1 Kaki Bukit Ave 3  
# 10-01 KB-1  
Singapore 416087  
Phone +65 6747 0998  
Fax +65 6746 3120  
www.metz-connect.com

**Shanghai Branch**

Room 1518, Xu Hui Business Building,  
168, Yu De Road,  
XuHui District, Shanghai 200030  
China  
Phone +86 21 3363 4228  
Phone +86 21 3363 4334  
Fax +86 21 3363 4224

